

**SPECIFICATION**

Voltage Rating : 250V AC RMS  
 Current Rating : 1A  
 Dielectric Withstanding Voltage:1000V AC RMS 60Hz  
 For 1 Minute.  
 Insulation Resistance:5000 Megohms Min.At 500V DC  
 Contact Resistance :25 Milliohms Max.  
 Durability: 20 Cycles  
 Temperature Range: -40°C To +105°C  
 Insulator : Glass-Reinforced Thermoplastic,Black  
 Contact : Phosphor Bronze  
 Plating: Tin Plated Over Nickel

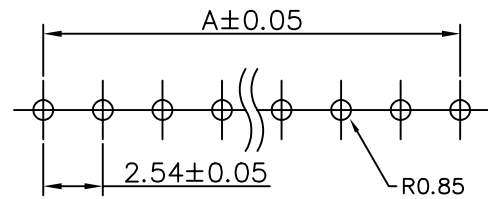

Recommended PCB Layout

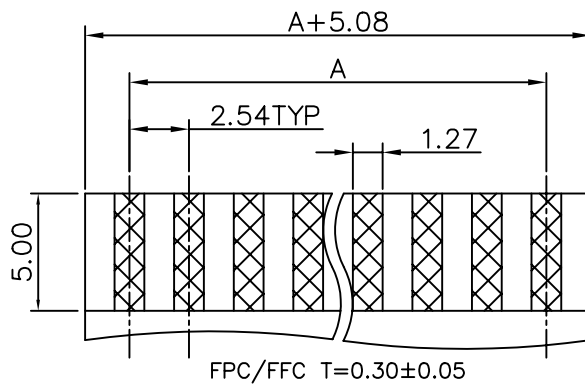
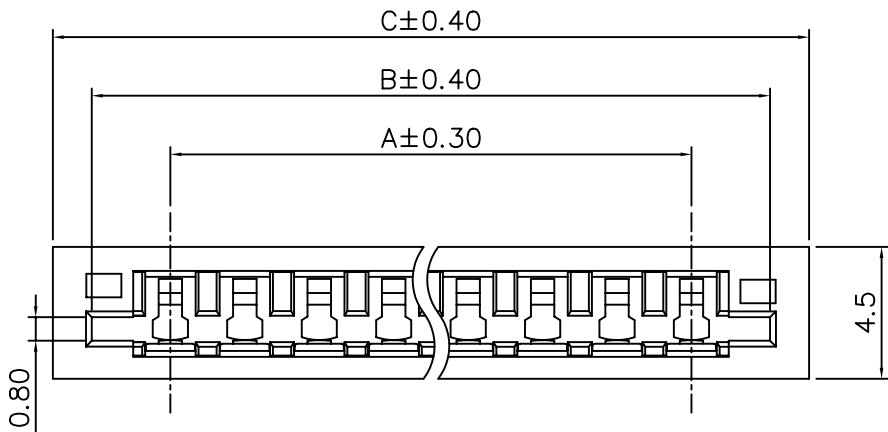
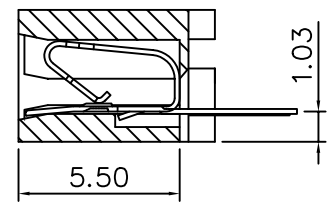

Circuit	A	B	C
2	2.54	8.43	10.54
3	5.08	10.97	13.08
4	7.62	13.51	15.62
5	10.16	16.05	18.16
6	12.70	18.59	20.70
7	15.24	21.13	23.24
8	17.78	23.67	25.78
9	20.32	26.21	28.32
10	22.86	28.75	30.86
11	25.40	31.29	33.40
12	27.94	33.83	35.94
13	30.48	36.37	38.48
14	33.02	38.91	41.02
15	35.56	41.45	43.56
16	38.10	43.99	46.10
17	40.64	46.53	48.64
18	43.18	49.07	51.18
19	45.72	51.60	53.72
20	48.26	54.15	56.26
21	50.80	56.69	58.80
22	53.34	59.23	61.34
23	55.88	61.77	63.88
24	58.42	63.76	66.42
25	60.96	66.85	68.96
26	63.50	69.39	71.50
27	66.04	71.93	74.04

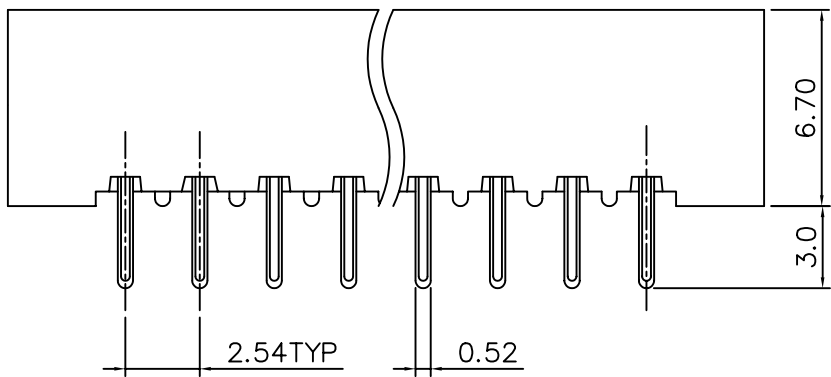

FFC NON ZIF STRAIGHT 2,54 mm

DRAWING No. FPC02D2

APPROVED BY MEI  
 CHECKED BY RAN  
 DRAWING BY HZF

UNLESS OTHERWISE SPECIFIED TOLERANCES ARE  
 .X ±0.3  
 .XX ±0.20  
 .XXX

SCALE NONE REV. UNIT mm

AREA REVISIONS CHK DATE